

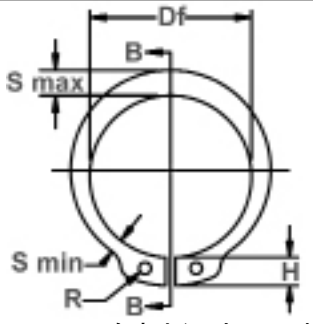

SHR 轴用偏心型扣环

轴用强化版C型扣环

对比普通轴用C型扣环 (SH)，此扣环板厚更厚，因此更加坚固，能经受较高的推力负荷。



自由直径&扣环尺寸
B-B 横断面图

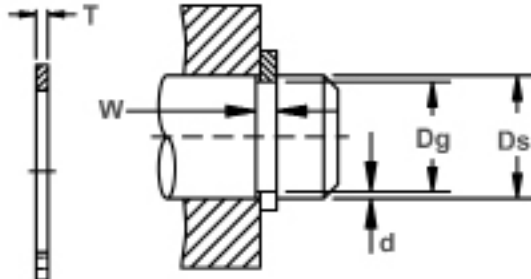

轴承直径&沟槽尺寸



直径间隙
(装置轴上时)

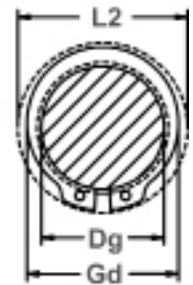

直径间隙&安装在沟槽时的扣环外径

扣环 编号	轴承 直径			沟槽尺寸					扣环尺寸&重量				间隙直径		承受推力 (lbs.) 无受面角部		
				沟槽直径		沟槽宽度		深度	自由直径		板厚***		重量 1000个	插入 轴承时	装载在 沟槽时	扣环 安全率 (=4)	沟槽 安全率 (=2)
	Ds DEC	Ds FRAC	Ds mm	Dg	公差	W	公差	d	Df	公差	T	Tol.	lbs.	L1	L2	Pr	Pg
SHR-39	.394	-	10.0	.368	+0.01	.039		.013	.362	+0.03	.035		.70	.61	.58	2030	700
SHR-42	.428	-	10.9	.402	-.002	.039	+0.03	.013	.394	-.008	.035		.86	.65	.62	2335	800
SHR-47	.473	-	12.0	.444	.002*	.046	-.000	.015	.435		.042		1.4	.69	.66	3045	1000
SHR-50	.500	1/2	12.7	.468		.056		.016	.460		.050	±0.02	1.6	.75	.72	3959	1100
SHR-59	.591	-	15.0	.555		.056	+0.04	.018	.543		.050		2.2	.86	.83	4568	1500
SHR-62	.625	5/8	15.9	.588		.056	-.000	.019	.575		.050		2.3	.90	.86	4872	1600
SHR-66	.669	-	17.0	.629		.056		.020	.616	+0.05	.050		2.6	.94	.90	5278	1900
SHR-75	.750	3/4	19.0	.704	+0.01	.086		.023	.689	-.010	.078		5.6	1.12	1.08	9135	2400
SHR-75	.787	-	20.0	.740	-.003	.086		.024	.689		.078		5.6	1.16	1.12	9135	2400
SHR-87	.875	7/8	22.2	.821	.002*	.086		.027	.804		.078		7.5	1.25	1.20	10556	3300
SHR-98	.984	63/64	25.0	.925		.086		.030	.906		.078		7.8	1.36	1.30	11673	4000
SHR-98	1.000	1	25.4	.938		.086		.031	.906		.078		7.8	1.37	1.31	11673	4000
SHR-106	1.062	1-1/16	27.0	.998		.103		.032	.978		.093		11.5	1.52	1.46	15225	4800
SHR-112	1.125	1-1/8	28.6	1.059		.103	+0.05	.033	1.036		.093	±0.03	12.5	1.58	1.52	16240	5200
SHR-118	1.181	-	30.0	1.111		.103	-.000	.035	1.087	+0.10	.093		13.5	1.64	1.57	16748	5600
SHR-118	1.188	1-3/16	30.2	1.111	+0.02	.103		.038	1.087	-.015	.093		13.5	1.64	1.57	16748	5600
SHR-125	1.250	1-1/4	31.7	1.174	-.004	.103		.038	1.150		.093		14.9	1.70	1.63	17763	6500
SHR-131	1.312	1-5/16	33.3	1.234	.004*	.103		.039	1.208		.093		16.0	1.77	1.69	18270	7400
SHR-137	1.375	1-3/8	34.9	1.291		.103		.042	1.268		.093		17.8	1.83	1.75	19793	8200
SHR-137	1.378	-	35.0	1.291		.103		.044	1.268		.093		17.8	1.83	1.75	19793	8200
SHR-150	1.500	1-1/2	38.1	1.406		.120		.047	1.380		.109		27.0	2.08	1.98	24868	10000
SHR-156	1.562	1-9/16	39.7	1.468		.120		.047	1.437		.109		31.0	2.14	2.05	26390	10400
SHR-156	1.575	-	40.0	1.480		.120		.048	1.437		.109		31.0	2.15	2.06	26930	10400
SHR-175	1.750	1-3/4	44.4	1.650		.120		.050	1.608		.109		33.4	2.34	2.25	29435	12400
SHR-175	1.772	-	45.0	1.669	+0.03	.120		.052	1.608	+0.13	.109		33.4	2.37	2.27	29435	12400
SHR-193	1.938	1-15/16	49.2	1.826	-.004	.139		.056	1.782	-.020	.125	±0.04	48.0	2.58	2.48	37555	15300
SHR-193	1.969	1-31/32	50.0	1.850	.004*	.139	+0.06	.060	1.782		.125		48.0	2.61	2.50	37555	15300
SHR-200	2.000	2	50.8	1.880		.139	-.000	.060	1.840		.125		50.6	2.64	2.53	38570	17000

单位: inch

* F.I.M. (指示器读数最大值): 沟槽直径—轴直径中心部允许存在最大偏差

† 以开孔/轴的冷延钢板为基准使用。关于为计算出负载推力，其他性能数据而使用的公式说明
如果需要，请联系我们。

*** 对于扣环需要实施电镀工艺，需要在板厚(T)基础上增加0.002inch。

但是最大板厚 (T)通常比所表示的沟槽宽度 (W)薄0.0002inch。

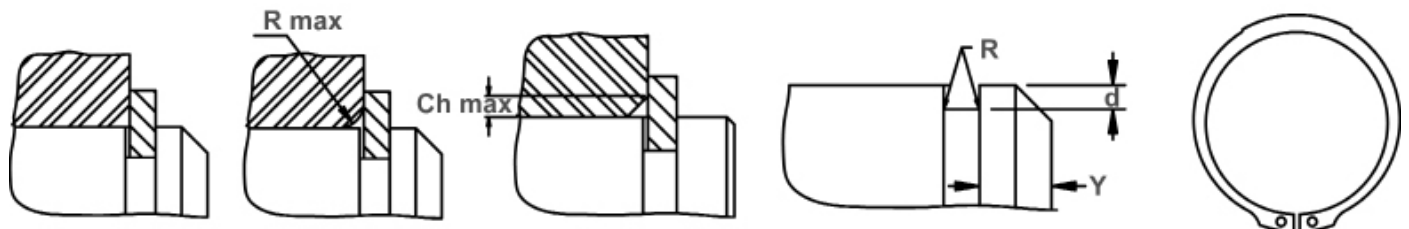

无受面角度

最大受面角度

沟槽扩展尺寸 & 边缘尺寸(Y)
最大底部半径 (R)

备用设计
(厂家选项)

SHR-39 ~ SHR-98 = .005
SHR-106 ~ SHR-200 = .010

扣环 编号	凸出部 高		最大 板幅		最小 板幅		安装孔 直径		扣环 外径 (安装在 沟槽内)	允许 受面角部			边缘 尺寸	R.P.M. 限制值	
	H	公差	s最大	公差	s最小	公差	R	公差		Gd最大	R最大	Ch最大			P'r
SHR-39	.101	±.004	.068	±.004	.039	±.004	.042	+.010		.479	.047	.039	450	.039	80000
SHR-42	.101		.076		.043		.042			.525	.057	.046	530	.039	72000
SHR-47	.101		.088		.053		.042			.589	.070	.058	550	.045	69000
SHR-50	.120		.090		.050		.050			.613	.070	.058	650	.048	65000
SHR-59	.130	±.005	.102	±.005	.057	±.005	.050			.719	.070	.058	750	.054	52500
SHR-62	.130		.106		.059		.050			.758	.074	.062	750	.057	49000
SHR-66	.130		.112		.062		.050			.808	.077	.064	900	.060	45000
SHR-75	.180	±.006	.127	±.006	.077	±.006	.078			.913	.089	.074	2500	.069	40500
SHR-75	.180		.127		.077		.078			.949	.089	.074	2500	.072	38000
SHR-87	.180		.148		.083		.078			1.056	.100	.083	2500	.081	34000
SHR-98	.180		.151		.084		.078			1.164	.100	.083	2500	.090	30000
SHR-98	.180	±.005	.151	±.007	.084	±.007	.078	+.015		1.177	.100	.083	2500	.093	30000
SHR-106	.220		.161		.090		.093			1.256	.106	.088	4000	.096	27000
SHR-112	.220		.169		.095		.093			1.329	.112	.093	4000	.099	26000
SHR-118	.220		.176		.098		.093			1.391	.112	.093	4000	.105	24000
SHR-118	.220		.176		.098		.093			1.391	.112	.093	4000	.114	24000
SHR-125	.220		.185		.103		.093			1.468	.112	.093	4000	.114	23000
SHR-131	.220		.192		.106		.093			1.538	.128	.107	4000	.117	21500
SHR-137	.220		.200		.110		.093			1.607	.128	.107	4000	.126	20500
SHR-137	.220		.200		.110		.093			1.607	.128	.107	4000	.132	20500
SHR-150	.280		±.008		.218		±.008			.123	±.008	.109	-.002		1.752
SHR-156	.280	.228		.127	.109	1.829		.128	.107	5000		.141			17000
SHR-156	.280	.228		.127	.109	1.841		.128	.107	5000		.144			17000
SHR-175	.290	.254		.140	.109	2.050		.128	.107	5000		.150			15500
SHR-175	.290	±.006	.254	±.006	.140	±.006	.109			2.069	.128	.107	5000	.156	15500
SHR-193	.314		.280		.154		.125			2.265	.153	.128	6000	.168	14300
SHR-193	.314		.280		.154		.125			2.289	.153	.128	6000	.180	14100
SHR-200	.314		.290		.160		.125			2.334	.153	.128	6000	.180	14000

单位: inch

如果需要其他尺寸, 请与我们联系。

硬度范围: 不锈钢制扣环 (PH 15-7Mo)

扣环型号	尺寸范围	规格	洛氏硬度
SHR	39 ~ 42	30N	63 ~ 69.5
	47 以上	C	44 ~ 51

硬度范围: 铍铜合金制扣环

扣环型号	尺寸范围	规格	洛氏硬度
SHR	39 ~ 42	30N	54 ~ 62
	47 以上	C	34 ~ 43

硬度范围: 碳素弹簧钢制扣环 (SAE 1060-1090)

扣环型号	尺寸范围	规格	洛氏硬度
SHR	39 ~ 62	30N	67.5 ~ 72
	66 以上	C	47 ~ 52

