

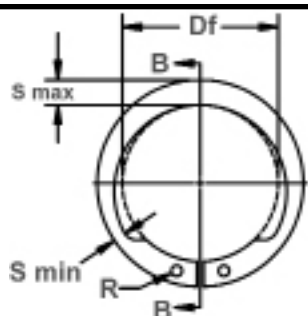

# SHI 轴用偏心型扣环

## 圆形S型扣环

具有与轴用C型扣环 (SH) 同样的功能  
由于此扣环延搁部反向突出, 可以确保扣环外周部的空间。



自由直径&扣环尺寸  
B-B 横断面图

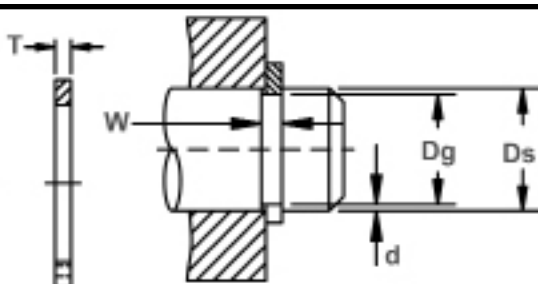

轴承直径&沟槽尺寸

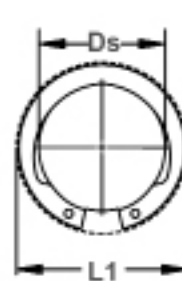

直径间隙  
(装置轴上时)

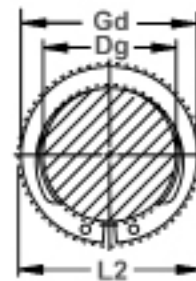

直径间隙&安装在沟槽时的扣环外径

扣环尺寸	轴承直径			沟槽尺寸					扣环尺寸&重量				间隙直径		i 负荷推力 (lbs.) 无受面角部		
				沟槽直径		沟槽宽度	深度	自由直径		板厚***		重量 1000个	插入 轴承时	装载在 沟槽时	扣环 安全率 (=4)	沟槽 安全率 (=2)	
	Ds DEC	Ds FRACT	Ds mm	Dg	公差	W	公差	d	Df	公差	T	公差	lbs.	L1	L2	Pr	Pg
SHI-50	.500	1/2	12.7	.468	±.002	.039		.016	.461		.035		1.0	.67	.645	1117	280
SHI-56	.562	9/16	14.3	.530	.004*	.039		.016	.521		.035		1.4	.75	.72	1269	320
SHI-59	.594	19/32	15.1	.559		.039		.017	.550		.035		1.6	.79	.76	1320	370
SHI-62	.625	5/8	15.9	.588		.039		.018	.579		.035		1.6	.83	.80	1421	400
SHI-68	.688	11/16	17.5	.646		.046		.021	.635		.042		2.5	.91	.87	2335	500
SHI-75	.750	3/4	19.0	.704	±.003	.046	+0.003	.023	.693	+0.005	.042		2.8	.99	.95	2538	600
SHI-78	.781	25/32	19.8	.733	.004*	.046	-0.000	.024	.722	-0.010	.042		3.1	1.04	1.00	2639	650
SHI-81	.812	13/16	20.6	.762		.046		.025	.751		.042		3.3	1.08	1.03	2690	700
SHI-87	.875	7/8	22.2	.821		.046		.027	.810		.042		3.8	1.15	1.10	2893	850
SHI-93	.938	15/16	23.8	.882		.046		.028	.867		.042		4.5	1.23	1.18	3147	900
SHI-100	.984	63/64	25.0	.926		.046		.029	.925		.042	±0.002	4.8	1.30	1.25	3350	1000
SHI-100	1.000	1	25.4	.940		.046		.030	.925		.042		4.8	1.31	1.26	3350	1050
SHI-106	1.062	1-1/16	27.0	.998		.056		.032	.982		.050		6.2	1.38	1.32	4212	1200
SHI-112	1.125	1-1/8	28.6	1.059		.056		.033	1.041		.050		6.7	1.45	1.39	4466	1300
SHI-118	1.188	1-3/16	30.2	1.118		.056		.035	1.098	+0.010	.050		7.2	1.52	1.46	4720	1450
SHI-125	1.250	1-1/4	31.7	1.176	±.004	.056	+0.004	.037	1.156	-0.015	.050		7.6	1.59	1.52	4974	1600
SHI-131	1.312	1-5/16	33.3	1.232	.005*	.056	-0.000	.040	1.214		.050		8.2	1.66	1.58	5227	1850
SHI-137	1.375	1-3/8	34.9	1.291		.056		.042	1.272		.050		8.4	1.73	1.65	5481	2050
SHI-143	1.438	1-7/16	36.5	1.350		.056		.044	1.333		.050		9.1	1.80	1.72	5735	2200
SHI-150	1.500	1-1/2	38.1	1.406		.056		.047	1.387		.050		9.8	1.87	1.78	5938	2500
SHI-156	1.562	1-9/16	39.7	1.468		.068		.047	1.446		.062		12.9	1.95	1.86	7714	2600
SHI-162	1.625	1-5/8	41.3	1.529		.068		.048	1.503		.062		13.4	2.02	1.93	8019	2750
SHI-177	1.750	1-3/4	44.4	1.650		.068		.050	1.637		.062		16.1	2.18	2.08	8628	3100
SHI-177	1.772	-	45.0	1.669	±.005	.068		.051	1.637	+0.013	.062		16.1	2.20	2.10	8628	3200
SHI-181	1.812	1-13/16	46.0	1.708	.005*	.068		.052	1.675	-0.020	.062		17.3	2.24	2.14	8983	3300
SHI-196	1.969	1-31/32	50.0	1.857		.068		.056	1.819		.062		20.5	2.43	2.32	9693	3900
SHI-200	2.000	2	50.8	1.886		.068		.057	1.850		.062		20.7	2.47	2.36	9896	4000
SHI-215	2.125	2-1/8	54.0	2.003		.086		.061	1.993		.078	±0.003	30.0	2.62	2.50	13195	4550
SHI-215	2.156	2-5/32	54.8	2.032		.086		.062	1.993	+0.015	.078		30.0	2.65	2.53	13195	4700
SHI-250	2.500	2-1/2	63.5	2.360		.086		.070	2.313	-0.025	.078		43.5	3.05	2.92	15530	6200
SHI-275	2.750	2-3/4	69.8	2.602	±.006	.103	+0.005	.074	2.543		.093		57.9	3.34	3.20	20402	7200
SHI-287	2.875	2-7/8	73.0	2.721	.006*	.103	-0.000	.077	2.659		.093		64.5	3.49	3.34	21315	7800
SHI-315	3.156	3-5/32	80.2	2.986		.103		.085	2.920	+0.020	.093		77.0	3.82	3.66	23447	9400
SHI-325	3.250	3-1/4	82.5	3.076		.103		.087	3.006	-0.030	.093		77.5	3.93	3.76	24056	10000
SHI-350	3.500	3-1/2	88.9	3.316		.120		.092	3.237		.109		107.0	4.22	4.04	30349	11500
SHI-393	3.938	3-15/16	100.0	3.734		.120		.102	3.642		.109		123.0	4.71	4.51	34206	14000

单位: inch

\* F.I.M. (指示器读数最大值): 沟槽直径一轴直径中心部允许存在最大偏差

i 以开孔/轴的冷延钢板为基准使用。关于为计算出负载推力, 其他性能数据而使用的公式说明  
如果需要, 请联系我们。

\*\*\* 对于扣环需要实施电镀工艺, 需要在板厚(T)基础上增加0.002inch。  
但是最大板厚(T)通常比所表示的沟槽宽度(W)薄0.0002inch。

硬度范围: 不锈钢制扣环 (PH 15-7Mo)

扣环型号	尺寸范围	规格	洛氏硬度
SHI	50 ~ 81	30N	63 ~ 69.5
	87 以上	C	44 ~ 51



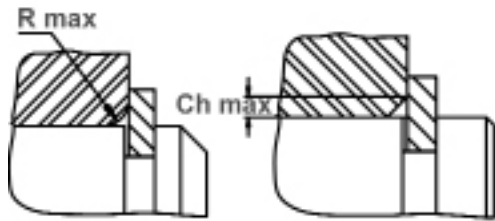

最大受面角度

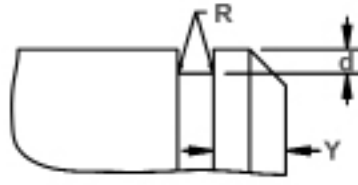

沟槽扩展尺寸 & 边缘尺寸(Y)  
最大底部半径 (R)  
SHI-50 ~ SHI-100 = .005  
SHI-106 ~ SHI-393 = .010

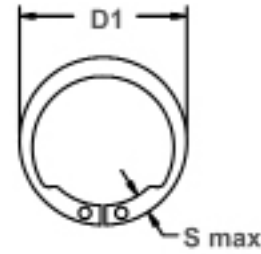

自由直径 (Df) 测量方法  
SHI 系列  
 $Df = D1 - 2(S \text{ 最大})$



备用设计  
(厂家选项)

扣环 编号	最大板宽 (包含凸出部)		最小板宽		安装孔 直径		扣环 外径 (安装在 沟槽中)	允许 受面角部			允许 受面角部 w/R最大或者 Ch最大时的 最大负荷 (in lbs.)	边缘 尺寸		R.P.M. 限制值
	s最大	公差	s最小	公差	R	公差		Gd最大	R最大	Ch最大		P'r	Y	
SHI-50	.080		.041		.042		.64	.051	.032	680	.048	40000		
SHI-56	.088	±.004	.043	±.004	.042		.715	.057	.036	680	.048	35000		
SHI-59	.092		.046		.042		.75	.059	.037	680	.052	32000		
SHI-62	.096		.048		.042	+0.010	.79	.062	.039	680	.055	30000		
SHI-68	.104		.052		.042	-.002	.87	.066	.042	1000	.063	28000		
SHI-75	.112		.056		.042		.945	.071	.045	1000	.069	26500		
SHI-78	.116		.057		.042		.98	.073	.046	1000	.072	25500		
SHI-81	.120	±.005	.060	±.005	.050		1.02	.076	.048	1000	.075	24500		
SHI-87	.128		.064		.050		1.095	.080	.051	1000	.081	23000		
SHI-93	.136		.068		.050		1.17	.086	.054	1000	.084	21500		
SHI-100	.144		.072		.050		1.24	.091	.057	1000	.087	20000		
SHI-100	.144		.072		.050		1.25	.091	.057	1000	.090	20000		
SHI-106	.147		.073		.078		1.31	.092	.058	1460	.096	19000		
SHI-112	.150		.075		.078		1.38	.093	.059	1460	.099	18800		
SHI-118	.153		.076		.078		1.45	.094	.059	1460	.105	18000		
SHI-125	.157	±.006	.079	±.006	.078	+0.015	1.52	.096	.060	1460	.111	17000		
SHI-131	.161		.080		.078	-.002	1.58	.097	.061	1460	.120	16500		
SHI-137	.165		.082		.078		1.65	.098	.061	1460	.126	16000		
SHI-143	.169		.085		.078		1.715	.100	.063	1460	.132	15000		
SHI-150	.173		.086		.078		1.775	.100	.063	1460	.141	14800		
SHI-156	.178		.089		.078		1.85	.104	.066	2250	.141	14000		
SHI-162	.183		.092		.078		1.92	.108	.067	2250	.144	13200		
SHI-177	.196		.098		.078		2.07	.116	.073	2250	.150	11700		
SHI-177	.196		.098		.078		2.09	.116	.073	2250	.153	11700		
SHI-181	.199		.100		.078		2.13	.117	.074	2250	.156	11500		
SHI-196	.212		.106		.078		2.31	.124	.078	2250	.168	10500		
SHI-200	.216		.108		.078		2.35	.127	.080	2250	.171	10000		
SHI-215	.229		.117		.120		2.49	.133	.084	3750	.183	9400		
SHI-215	.229	±.007	.117	±.007	.120		2.52	.133	.084	3750	.186	9400		
SHI-250	.250		.130		.120		2.91	.151	.095	3750	.210	8400		
SHI-275	.280		.140		.120		3.19	.165	.103	5500	.222	7600		
SHI-287	.290		.145		.120		3.33	.170	.107	5500	.231	7300		
SHI-315	.316		.159		.120		3.65	.185	.116	5500	.255	6500		
SHI-325	.324	±.008	.162	±.008	.120		3.75	.190	.118	5500	.261	6400		
SHI-350	.345		.173		.125		4.03	.202	.127	7850	.276	5900		
SHI-393	.368		.183		.125		4.50	.212	.133	7850	.306	5200		

单位: mm

如果需要所示尺寸之外的型号, 请联系我们。

硬度范围: 碳素弹簧钢制扣环 (SAE 1060-1090)

扣环型号	尺寸范围	规格	洛氏硬度
SHI	50 ~ 81	30N	66 ~ 71
	87 ~ 102	C	47 ~ 53
	106 ~ 343	C	47 ~ 52
	350 以上	C	45 ~ 50

硬度范围: 铍铜合金制造扣环

扣环型号	尺寸范围	规格	洛氏硬度
SHI	50 ~ 81	30N	56.5 ~ 62
	87 以上	C	37 ~ 43

