

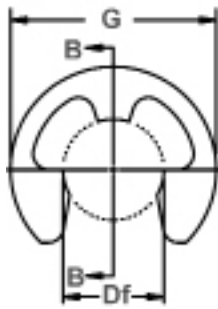

# E 轴用偏心型扣环

## E型扣环

“E”环可能是最流行和被广泛使用的轴用扣环。正如其名，此扣环形似字母“E”。E型扣环有3个突出部分与沟槽接触，因而具有制动的功能。



自由直径&扣环尺寸  
B-B 横断面图

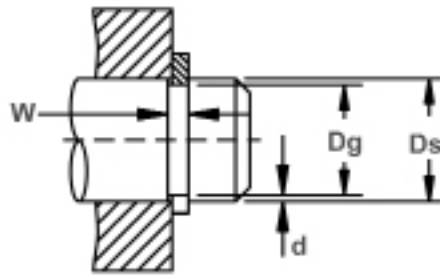

轴承直径&沟槽尺寸



直径间隙  
(当安装在沟槽时)

扣环 编号	轴承直径			沟槽尺寸			扣环尺寸&重量						间隙直径		↑负载推力 (lbs.)		
				沟槽直径	沟槽宽度	深度	自由直径			板厚***	重量 1000个	自由 外径 参考	安装在 沟槽中	无受面角部			
	Dg	公差	W				公差	d	Df					公差	T	公差	lbs.
**E-4	.040	-	1.0	.026	.012		.007	.025		.010		±.001	.009	.079	.090	13	6
E-6	.062	1/16	1.6	.052	.012		.005	.051	+ .001	.010		±.001	.030	.156	.165	20	7
SE-6	.062	1/16	1.6	.052	.012		.005	.051	- .003	.010		±.001	.028	.140	.150	20	7
YE-6	.062	1/16	1.6	.052	.023	+ .002	.005	.051		.020		±.002	.094	.187	.200	41	7
SE-9	.094	3/32	2.4	.074	.020	+ .002	.010	.069	+ .002-.003	.015		±.002	.10	.230	.245	46	20
E-9	.094	3/32	2.4	.074	.020	*.0015	.010	.073		.015		±.002	.058	.187	.200	46	20
SE-11	.110	7/64	2.8	.079	.020		.015	.076		.015		±.002	.31	.375	.390	61	40
SE-12	.125	1/8	3.2	.095	.029		.015	.094		.025		±.002	.12	.214	.225	110	45
E-12	.125	1/8	3.2	.095	.020		.015	.094		.015		±.002	.087	.230	.240	66	45
SE-14	.140	9/64	3.6	.102	.020		.019	.100		.015		±.002	.060	.203	.215	76	60
YE-14	.140	9/64	3.6	.110	.020		.015	.108		.015		±.002	.10	.250	.265	76	45
E-14	.140	9/64	3.6	.105	.029		.017	.102	+ .001	.025		±.002	.21	.270	.285	173	60
SE-15	.156	5/32	4.0	.118	.046		.019	.116	- .003	.042		±.002	.76	.375	.390	300	70
E-15	.156	5/32	4.0	.116	.029	+ .002	.020	.114		.025		±.002	.21	.282	.295	178	75
SE-17	.172	11/64	4.4	.127	.029	- .000	.022	.125		.025		±.002	.24	.312	.325	183	90
SE-18	.188	3/16	4.8	.125	.029	*.002	.031	.122		.025		±.002	.45	.375	.39	203	135
YE-18	.188	3/16	4.8	.147	.029		.020	.145		.025		±.002	.70	.470	.485	193	90
ZE-18	.188	3/16	4.8	.125	.029		.031	.122		.025		±.002	1.05	.550	.565	203	135
E-18	.188	3/16	4.8	.147	.029		.020	.145		.025		±.002	.29	.335	.35	193	90
SE-21	.219	7/32	5.6	.188	.029		.015	.185		.025		±.002	.47	.437	.45	228	75
E-25	.250	1/4	6.3	.210	.029		.020	.207		.025		±.002	.76	.527	.54	259	115
SE-31	.312	5/16	7.9	.250	.029	+ .003	.031	.243		.025		±.002	.57	.500	.52	330	225
YE-31	.312	5/16	7.9	.250	.029	- .000	.031	.243		.025		±.002	1.220	.670	.685	325	220
SE-37	.375	3/8	9.5	.306	.039		.034	.303	+ .002	.035		±.002	1.050	.567	.587	680	300
E-37	.375	3/8	9.5	.303	.039	+ .003	.036	.300	- .004	.035		±.002	1.5	.660	.68	700	315
E-43	.438	7/16	11.1	.343	.039	- .000	.047	.337		.035		±.002	1.5	.687	.71	842	480
SE-43	.438	7/16	11.1	.380	.039	*.004	.029	.375		.035		±.002	1.0	.600	.62	812	280
E-50	.500	1/2	12.7	.396	.046		.052	.392		.042		±.002	2.5	.800	.82	1127	600
E-62	.625	5/8	15.9	.485	.046		.070	.480		.042		±.002	3.2	.940	.96	1441	1050
SE-74	.750	3/4	19.0	.625	.056		.062	.616	+ .003	.050		±.002	4.3	1.000	1.02	1979	1100
E-75	.750	3/4	19.0	.580	.056		.085	.574	- .005	.050		±.002	5.8	1.120	1.14	2030	1500
E-87	.875	7/8	22.2	.675	.056		.100	.668		.050		±.002	7.6	1.300	1.32	2385	2050
SE-98	.984	63/64	25.0	.835	.056		.074	.822		.050		±.002	9.2	1.500	1.53	2639	1750
SE-98	1.000	1	25.4	.835	.056		.082	.822		.050		±.002	9.2	1.500	1.53	2690	1900
SE-118	1.188	1-3/16	30.2	1.079	.068	+ .005	.054	1.066	+ .006	.062		±.003	11.3	1.626	1.67	3501	1500
SE-137	1.375	1-3/8	34.9	1.230	.068	+ .004	.072	1.213	- .010	.062		±.003	15.4	1.875	1.92	4162	2350

单位: inch

此处所示沟槽宽度 (W) 为最小值

\*F.I.M. (指示器读数最大值): 沟槽直径—轴直径中心部允许存在最大偏差。

↑以开孔/轴的冷延钢板为基准使用。关于为计算出负载推力, 其他性能数据而使用的公式说明

如果需要, 请联系我们。

\*\*对于扣环需要实施电镀工艺, 需要在板厚(T)基础上增加0.002inch。

但是最大板厚 (T)通常比所表示的沟槽宽度 (W)薄0.0002inch。

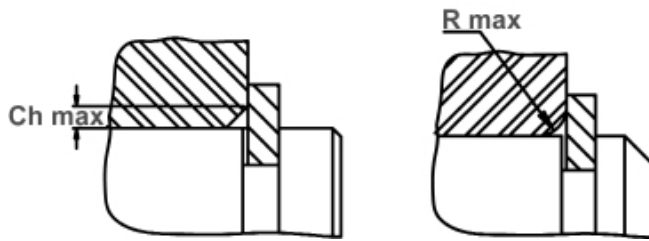

最大受面角度

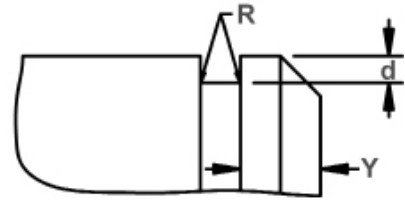

沟槽扩展尺寸 & 边缘尺寸(Y)

- 最大底部半径 (R)
- 扣环尺寸-4 ~ 6 = 锐角
- 扣环尺寸-9 ~ 25 = 0.005
- 扣环尺寸-31 ~ 43 = 0.010
- 扣环尺寸-50 ~ 137 = 0.015

扣环编号	允许受面角部		R最大 Ch最大 最大受力 (ibs.)	边缘尺寸 Y	R.P.M. 限制值
	R最大	Ch最大			
**E-4	.015	.010	13	.014	40000
E-6	.030	.020	20	.010	40000
SE-6	.030	.020	20	.010	40000
YE-6	.035	.025	40	.010	40000
SE-9	.053	.040	45	.020	36000
E-9	.040	.030	45	.020	36000
SE-11	.080	.060	60	.030	35000
SE-12	.040	.030	108	.030	35000
E-12	.040	.030	65	.030	35000
SE-14	.029	.022	75	.038	32000
YE-14	.040	.030	75	.030	32000
E-14	.060	.045	170	.034	32000
SE-15	.080	.060	250	.038	31000
E-15	.060	.045	175	.040	31000
SE-17	.060	.045	180	.044	30000
SE-18	.060	.045	200	.062	30000
YE-18	.060	.045	190	.040	25000
ZE-18	.060	.045	200	.062	18000
E-18	.060	.045	190	.040	30000
SE-21	.060	.045	225	.030	26000
E-25	.060	.045	255	.040	25000
SE-31	.060	.045	325	.062	22000
YE-31	.060	.045	320	.062	15000
SE-37	.060	.045	680	.068	20000
E-37	.065	.050	690	.072	20000
E-43	.065	.050	830	.094	16500
SE-43	.050	.035	800	.058	16500
E-50	.080	.060	1110	.104	14000
E-62	.080	.060	1420	.140	12000
SE-74	.057	.042	1900	.124	11000
E-75	.085	.065	2000	.170	10500
E-87	.085	.065	2350	.200	9000
SE-98	.085	.065	2700	.148	6500
SE-98	.077	.057	2700	.164	6500
SE-118	.090	.070	3450	.108	5500
SE-137	.090	.070	4100	.144	4000

单位:inch

如需其他尺寸, 请与我们联系。

硬度范围: 不锈钢制扣环 (PH 15-7Mo)

扣环型号	尺寸范围	规格	洛氏硬度
E 全	E6 ~ SE6	15N	82.5 ~ 86*
	YE6 ~ YE14	15N	82.5 ~ 86
	E14 ~ SE31	30N	63 ~ 69.5
	E37 以上	C	44 ~ 51

硬度范围: 铍铜合金制扣环

扣环型号	尺寸范围	规格	洛氏硬度
E 全	E4 ~ SE6	15N	79 ~ 82*
	YE6 ~ YE14	15N	79 ~ 82
	E14 ~ SE31	30N	56.5 ~ 62
	E37 以上	C	37 ~ 43

硬度范围: 碳素弹簧钢制扣环 (SAE 1060-1090)

扣环型号	尺寸范围	规格	洛氏硬度
E 全	E6 ~ SE6	15N	84.5 ~ 87*
	YE6 ~ YE14	15N	84.5 ~ 87
	E14 ~ SE31	30N	66.5 ~ 71
	E37 以上	C	47 ~ 52

\*无法确认相同尺寸的扣环硬度精度。

