



KLR 开孔用螺旋环

开孔用单卷型-重负载型

适用于应对重负载的

单卷螺旋环

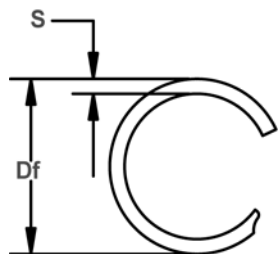

自由直径&扣环尺寸

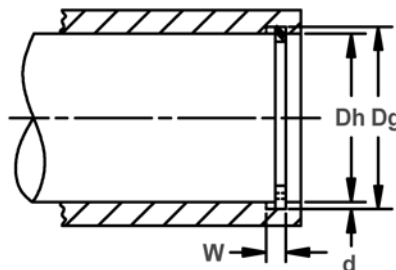
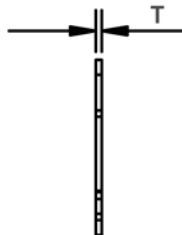

开孔直径&沟槽尺寸

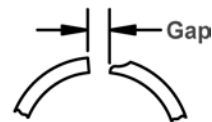

可选择前端部设计

扣环 编号	开孔直径		沟槽尺寸				扣环尺寸					承受推力 (lbs.)		
	Dh (In.)	Dg	沟槽直径		沟槽宽度		自由直径		板厚		板宽		扣环 安全率 (=3)	沟槽 安全率 (=2)
			公差	W	公差	Df	公差	T	公差	s	公差			
KLR-50	.500	.524		.043		.529		.037		.055		2325	424	
KLR-56	.562	.586	+0.004	.043		.591		.037		.055		2613	477	
KLR-62	.625	.657	-0.000	.043		.665	+0.013	.037		.065		2906	707	
KLR-68	.687	.719		.043		.726	-0.000	.037		.065		3194	777	
KLR-75	.750	.790	+0.005	.043		.797		.037		.075		3487	1060	
KLR-81	.812	.852	-0.000	.043		.860		.037		.075		3775	1148	
KLR-87	.875	.915		.043		.924		.037		.075		4068	1237	
KLR-93	.937	.985		.051		1.000		.045		.085		5334	1590	
KLR-100	1.000	1.048	+0.008	.051		1.058		.045		.085		5693	1696	
KLR-106	1.062	1.110	-0.000	.051		1.121		.045		.094		6045	1802	
KLR-112	1.125	1.181		.051		1.192		.045	±0.002	.094	±0.004	6404	2227	
KLR-118	1.187	1.243		.051		1.252	+0.015	.045		.094		6757	2349	
KLR-125	1.250	1.316		.051		1.336	-0.000	.045		.094		7116	2916	
KLR-131	1.312	1.378		.051		1.391		.045		.094		7469	3060	
KLR-137	1.375	1.453		.063		1.470		.057		.128		9307	3791	
KLR-143	1.437	1.515	+0.010	.063		1.529		.057		.128		9727	3961	
KLR-150	1.500	1.578	-0.000	.063		1.592		.057		.128		10153	4135	
KLR-156	1.562	1.666		.073		1.687		.067		.158		12400	5741	
KLR-162	1.625	1.729		.073	+0.006	1.746		.067		.158		12901	5973	
KLR-168	1.687	1.791	-0.000	.073	-0.000	1.808	+0.020	.067		.158		13393	6201	
KLR-175	1.750	1.862		.073		1.885	-0.000	.067		.158		13893	6927	
KLR-181	1.812	1.924		.073		1.942		.067		.158		14385	7173	
KLR-187	1.875	1.987		.073		2.007		.067		.158		14885	7422	
KLR-193	1.937	2.055		.085		2.074		.076		.200		16649	8078	
KLR-200	2.000	2.118		.085		2.143		.076		.200		17191	8341	
KLR-206	2.062	2.180		.085		2.200		.076		.200		17724	8599	
KLR-212	2.125	2.243		.085		2.264		.076		.200		18265	8862	
KLR-218	2.187	2.305		.085		2.327	+0.025	.076		.200		18798	9121	
KLR-225	2.250	2.368		.085		2.389	-0.000	.076		.200		19340	9384	
KLR-231	2.312	2.430	+0.012	.085		2.453		.076		.200		19873	9642	
KLR-237	2.375	2.493	-0.000	.085		2.517		.076		.200		20414	9905	
KLR-243	2.437	2.555		.085		2.582		.076		.200		20947	10163	
KLR-250	2.500	2.618		.085		2.643		.076		.200		21488	10426	
KLR-256	2.562	2.680		.104		2.705		.095		.200		26225	10685	
KLR-262	2.625	2.743		.104		2.777		.095	±0.003	.200	±0.005	26870	10947	
KLR-268	2.687	2.805		.104		2.828		.095		.200		27504	11206	
KLR-275	2.750	2.868		.104		2.899		.095		.200		28149	11469	
KLR-281	2.812	2.930		.104		2.958	+0.030	.095		.200		28784	11727	
KLR-287	2.875	2.993		.104		3.022	-0.000	.095		.200		29429	11990	
KLR-293	2.937	3.055		.104		3.084		.095		.200		30063	12249	
KLR-300	3.000	3.118		.104		3.145		.095		.200		30708	12511	
KLR-306	3.062	3.184		.104		3.218		.095		.200		31343	13203	
KLR-312	3.125	3.263	+0.013	.104		3.294		.095		.237		31988	15242	
KLR-318	3.187	3.325	-0.000	.104		3.357		.095		.237		32622	15544	
KLR-325	3.250	3.388		.104		3.420		.095		.237		33267	15851	

单位: inch



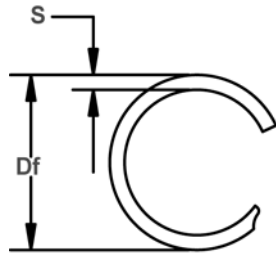

自由直径&扣环尺寸

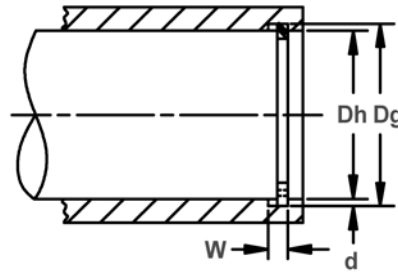
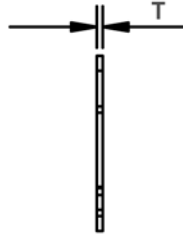

开孔直径&沟槽尺寸

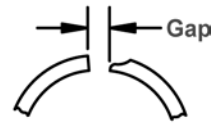

可选择前端部设计

扣环 编号	开孔直径		沟槽尺寸				扣环尺寸					承受推力 (lbs.)		
	(In.)	Dh	沟槽直径		沟槽宽度		自由直径		板厚		板宽		扣环 安全率 (=3)	沟槽 安全率 (=2)
			Dg	公差	W	公差	Df	公差	T	公差	S	公差		
KLR-331	3.312	3.450			.124		3.483		.115		.248		38952	16154
KLR-337	3.375	3.513			.124		3.547		.115		.248		39693	16461
KLR-343	3.437	3.575			.124		3.609		.115		.248		40422	16763
KLR-350	3.500	3.638			.124		3.673		.115		.248		41163	17071
KLR-356	3.562	3.700	+0.013		.124		3.728	+0.035	.115	±0.003	.248		41892	17373
KLR-362	3.625	3.763	-0.000		.124		3.799	-0.000	.115		.248		42633	17680
KLR-368	3.687	3.825			.124		3.862		.115		.248		43362	17983
KLR-375	3.750	3.888			.124		3.922		.115		.248		44103	18290
KLR-381	3.812	3.950			.124		3.988		.115		.248		44832	18592
KLR-387	3.875	4.013			.124		4.044		.115		.248		45573	18900
KLR-393	3.937	4.075			.124		4.114		.115		.248		46302	19202
KLR-400	4.000	4.158			.163		4.223		.153		.265	±0.005	60283	22337
KLR-412	4.125	4.283	+0.021		.163		4.329		.153		.265		62166	23035
KLR-425	4.250	4.408	-0.000		.163		4.452		.153		.265		64050	23733
KLR-437	4.375	4.533			.163		4.576		.153		.265		65934	24431
KLR-450	4.500	4.658			.163		4.703	+0.050	.153		.265		67818	25129
KLR-462	4.625	4.783			.163		4.829	-0.000	.153		.265		69702	25827
KLR-475	4.750	4.908			.163		4.945		.153		.265		71585	26525
KLR-487	4.875	5.033			.163		5.082		.153		.265		73469	27223
KLR-500	5.000	5.158			.163		5.207		.153		.265		75353	27921
KLR-525	5.250	5.408	+0.024		.163	+0.007	5.460		.153	±0.004	.265		79121	29317
KLR-550	5.500	5.658	-0.000		.163	-0.000	5.719		.153		.265		82888	30713
KLR-575	5.750	5.908			.163		5.965		.153		.265		86656	32109
KLR-600	6.000	6.196			.163		6.256		.153		.316		90424	41563
KLR-625	6.250	6.446			.163		6.508	+0.055	.153		.316		94191	43295
KLR-650	6.500	6.696			.163		6.760	-0.000	.153		.316		97959	45027
KLR-675	6.750	6.946			.163		7.013		.153		.316		101727	46759
KLR-700	7.000	7.196			.163		7.266		.153		.316		105494	48490
KLR-725	7.250	7.446			.163		7.541		.153		.316		109262	50222
KLR-750	7.500	7.696			.163		7.762		.153		.316		113030	51954
KLR-775	7.750	7.946			.163		8.023		.153		.316	±0.006	116797	53686
KLR-800	8.000	8.196	+0.028		.163		8.276		.153		.316		120565	55418
KLR-825	8.250	8.486	-0.000		.203		8.580		.192		.373		147399	68813
KLR-850	8.500	8.736			.203		8.821		.192		.373		151866	70898
KLR-875	8.750	8.986			.203		9.073	+0.070	.192		.373		156332	72983
KLR-900	9.000	9.236			.203		9.326	-0.000	.192		.373		160799	75068
KLR-925	9.250	9.486			.203		9.580		.192		.373		165265	77154
KLR-950	9.500	9.736			.203		9.831		.192	±0.005	.373		169732	79239
KLR-975	9.750	9.986			.203		10.083		.192		.373		174199	81324
KLR-1000	10.000	10.314			.203		10.414		.192		.435		178665	110977
KLR-1025	10.250	10.564	+0.031		.203		10.660		.192		.435		183132	113751
KLR-1050	10.500	10.814	-0.000		.203		10.919		.192		.435	±0.007	187599	116526
KLR-1075	10.750	11.064			.203		11.171		.192		.435		192065	119300
KLR-1100	11.000	11.314			.203		11.440	+0.120-0.000	.192		.435		196532	122074

单位: inch

